



Sylvan Avenue

Offers In Excess Of £1,000,000

2170 sq ft - Located in a tree-lined road, within a stones throw of trendy Mill Hill Broadway, is this 6 bedroom 2/3 reception room detached family home, in need of complete modernisation. The property is ideally suited to the discerning buyer who is looking to make this a wonderful family home. The property boasts high ceilings throughout, characterful features and with potential to extend stpp.

The property is located in one of Mill Hill's premier addresses and is close to excellent local schools, places of worship and the Thameslink Station.

Viewing Highly Recommended. Sole Agent. Chain Free.

Viewing

Please contact our Mill Hill Office on 020 8959 0011 if you wish to arrange a viewing appointment for this property or require further information.



6



2



3



G

Floor Plan

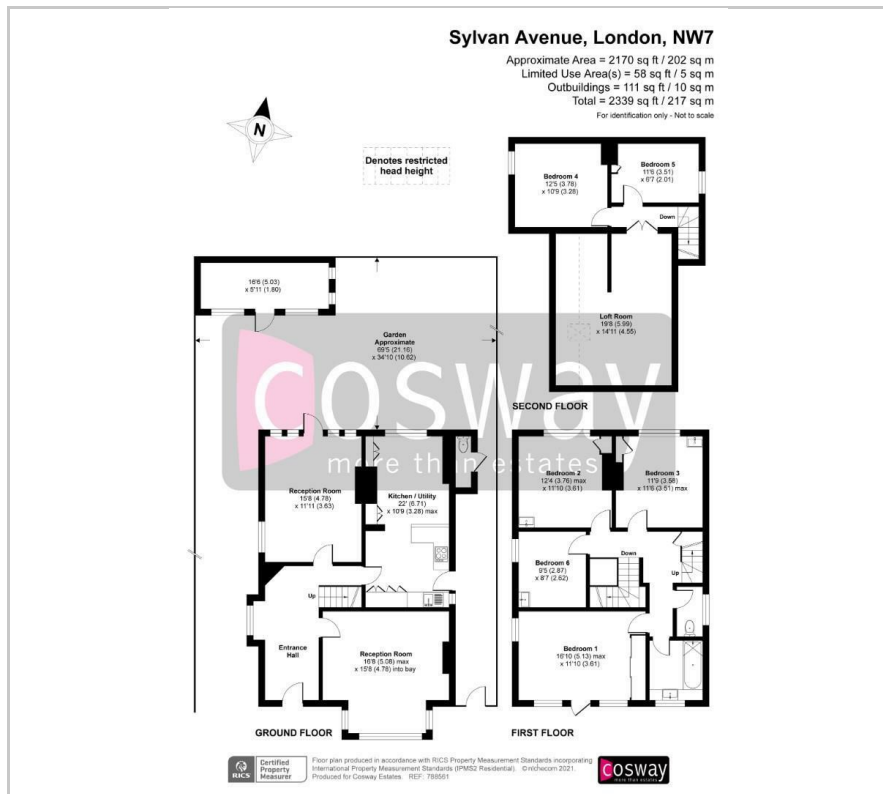

Area Map



Energy Efficiency Graph

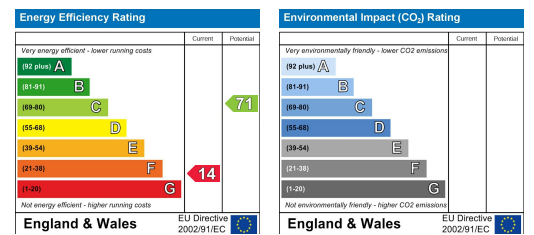

These particulars, whilst believed to be accurate are set out as a general outline only for guidance and do not constitute any part of an offer or contract. Intending purchasers should not rely on them as statements of representation of fact, but must satisfy themselves by inspection or otherwise as to their accuracy. No person in this firm's employment has the authority to make or give any representation or warranty in respect of the property.